

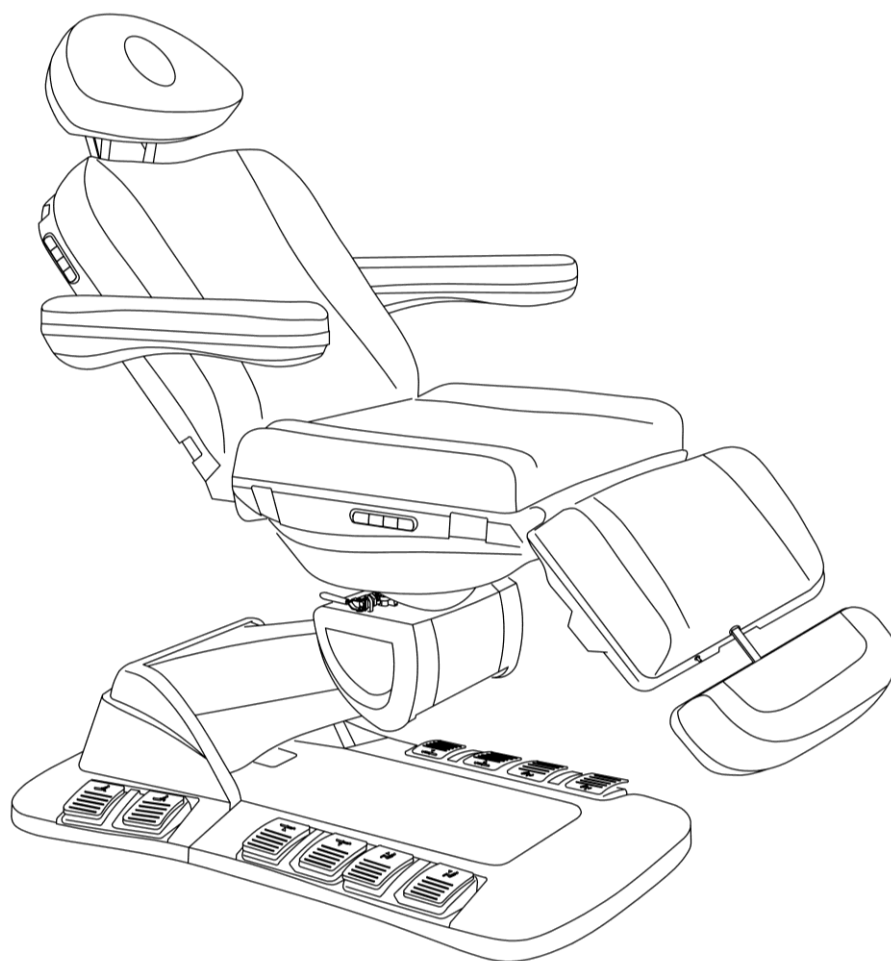

ARIA
SPA TREATMENT TABLE



User Manual

YNH-FCCHR-81016A

INTRODUCTION

Thank you for choosing Dermalogic ARIA Spa Treatment Table. Dermalogic is an AYC's registered trademark for elegant and well-designed spa salon furnishings and appliances. We strive to bring quality, dependability and affordability when properly used.

PLEASE TAKE TIME TO READ THIS MANUAL THOROUGHLY BEFORE USE. If you have any questions or concerns with your spa treatment table, please contact our customer service and technical support at 972-926-6488 ext. 2, Monday through Friday 9AM – 5PM or email us at service@ayc LLC.com.

SHIPMENT INSPECTION

Thoroughly inspect each shipment immediately upon arrival. It is very important that you notify the driver directly and note any damage or irregularities on the delivery receipt. Failure to note damage on the delivery receipt may prevent any claims you may have against the carrier.

If concealed loss or damage is found, you MUST report it to AYC within 72 hours of delivery and DO NOT DISCARD THE SHIPPING CARTON. Failure to do so constitutes acceptance of the shipment as-is and in good order and, additionally, waives any right to collect possible compensation from shipping claims.

SPA TABLE ACCESSORIES

- Power Cord x 1
- Hand Controller x 1
- Headrest x 1
- Armrest x 2

NOTE: Please check all the accessories that are contained after unpacking

SPECIFICATIONS

- Model: YNH-FCCHR-81016A
- Rated Output/Input Voltage: AC 110V-240V
- Product Net Weight: 155lbs +/-
- Fabric Material: Synthetic PVC Leather
- Base Cover Material: ABS Plastic
- Weight Capacity: 450 lbs
- Size: 73" L x 23" W x (25-39)"H
- Rotating Armrests: 0°-180°
- Backrest Adjustment Range: 0°-80°
- Legrest Adjustment Range: 0°-83°

Adjustable backrest

(0°-80°)

Rotating armrest
(0°-180°)

Inclinable Seat
(7°)

Width (23")

Height adjustment
(25"-39")

Rotation angle
(+/-120°)

Adjustable legrest
(0°-83°)

Total length (73")



PRECAUTION

- Maintain a distance of at least 20 cm between the control box, hand control, and high-frequency equipment to avoid interference.
- Ensure power cables and plugs are intact before use. Any damage should be addressed by professionals or service providers.
- Verify that the voltage matches the specified safety voltage. Using incorrect voltage can cause product damage.
- When in use, the product may draw a current of 10A or more. Choose a power outlet capable of handling high current and, if possible, use a dedicated outlet to prevent power failure or fire hazards.
- Avoid handling the product with wet hands to prevent electric shock.
- Do not plug in the product before completing installation.
- Position power cables to prevent tripping hazards.
- Clean the product's surface with a soft towel and diluted neutral detergent.
- Unplug the product when not in use.
- Do not disassemble the product without manufacturer authorization.

HEALTH WARNING

Individuals with the following conditions should avoid spa treatment.

- Medical conditions, such as osteoporosis or heart-related issues.
- Pregnancy or menstruation.
- Injuries or disabilities.
- Unconsciousness or illness.
- Children under 14 years old without supervision.

If the client experiences any pain or discomfort, discontinue the spa treatment immediately.

OPERATION INSTRUCTION

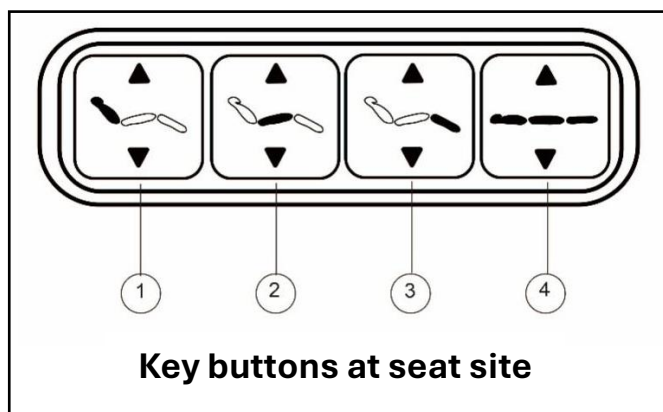
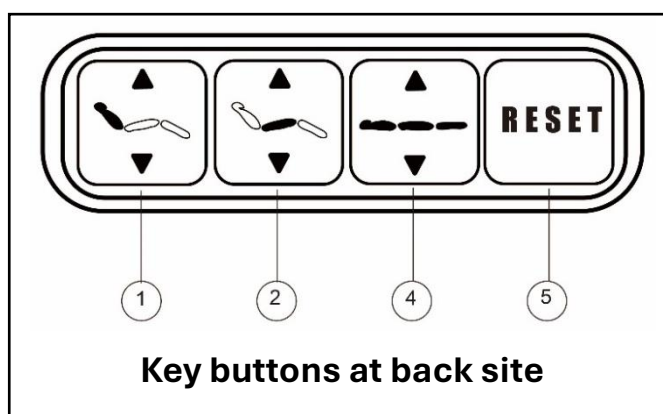
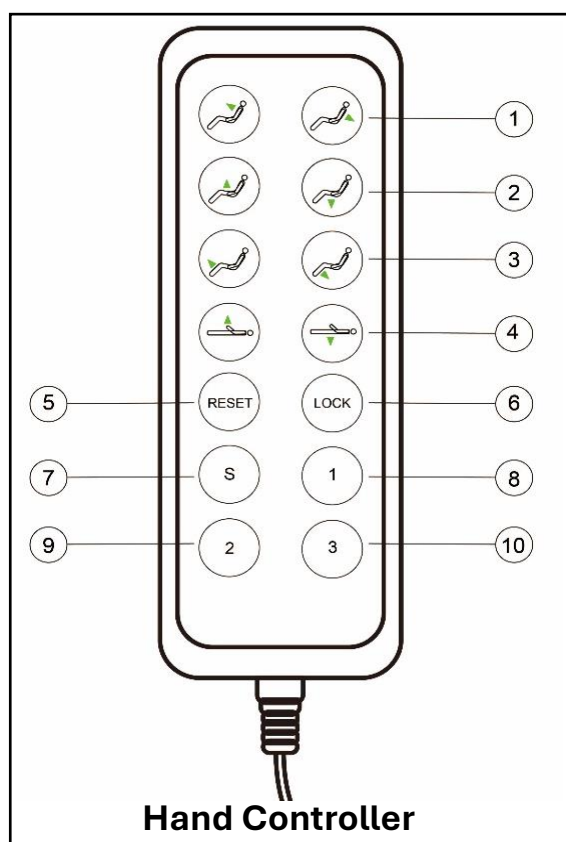

	Description	Operation
①	Backrest angle button	Angle of backrest increase/decrease by pressing the button.
②	Seat angle button	Angle of seat cushion increase/decrease by pressing the button.
③	Footrest angle button	Angle of footrest increase/decrease by pressing the button.
④	Height adjust button	The whole bed goes up/down by pressing the button.
⑤	Reset button	Press the button for about three seconds, the backrest angle will automatically move to the maximum, the seat cushion angle will automatically move to the minimum, the footrest angle will automatically move to the maximum, the height will automatically reach the lowest position.

	Description	Operation
⑥	Lock button	The indicator light is on by pressing the button, all the buttons are locked. The indicator goes off by pressing the button, all the buttons are unlocked.
⑦	Enter the memory position setting	The indicator light is on by pressing the button, then enter the memory position setting state.
⑧	Memory position setting 1	1. Adjust the spa treatment table to the preset position. 2. Press the ⑦ button, after entering the memory position setting state, press the button ⑧ or ⑨ or ⑩, then the preset position will be set into memory. 3. Press the button ⑧ or ⑨ or ⑩ for about three seconds, and it will return to the memorized position.
⑨	Memory position setting 2	
⑩	Memory position setting 3	

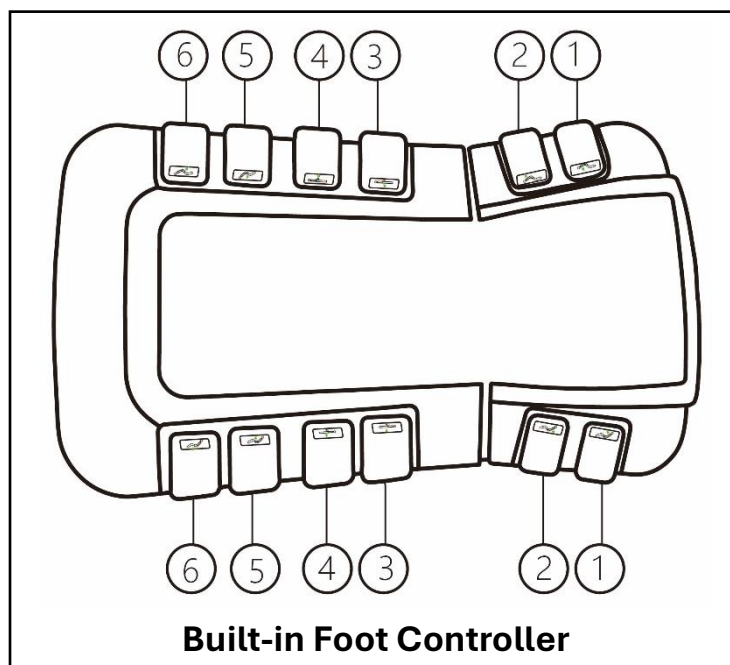

① Backrest angle button - Up

② Backrest angle button - Down

③ High adjust button - Up

④ High adjust button - Down

⑤ Footrest angle button - Up

⑥ Footrest angle button - Down

TROUBLESHOOTING

Name	Causes of Damage	Fault Manifestation	Maintenance Suggestions
Screws	<ul style="list-style-type: none"> • Long-term vibration. • Environmental factors causing rust or corrosion. 	<ul style="list-style-type: none"> • Parts become loose, shake, displace, or fall off. • Compromised stability and safety of the equipment. 	<ul style="list-style-type: none"> • Regularly inspect screw tightness. • Replace any rusted or corroded screws promptly.
Motors	Prolonged use or overload leading to overheating, wear, or failure.	The spa treatment table fails to lift or adjust angles properly.	<ul style="list-style-type: none"> • Inspect the motor regularly. • Repair or replace it if necessary.
Wires and Plugs	<ul style="list-style-type: none"> • Frequent plugging/unplugging. • Bending, aging, or damage to wire insulation. • Loose plugs or short circuits. 	<ul style="list-style-type: none"> • Electrical faults, power failure, or leakage. • Safety hazards. 	Inspect and replace damaged wires and plugs regularly.
Mattress	<ul style="list-style-type: none"> • Long-term weight bearing. • Friction or erosion from cleaning products causing deformation or wear. 	<ul style="list-style-type: none"> • Reduced customer comfort. • Potential skin irritation or other issues. 	Replace the mattress periodically to ensure comfort and hygiene.
Hand/Foot Controllers	Frequent use, key wear, or aging of electronic components.	The controller fails to function properly, impacting the ability to control the beauty bed.	Regularly check and repair or replace the controller when necessary.

TROUBLESHOOTING

Name	Causes of Damage	Fault Manifestation	Maintenance Suggestions
ABS cover	<ul style="list-style-type: none"> • Long-term exposure to sunlight. • Corrosion by chemical cleaners. • Physical impact causing fading, cracks, deformation, or damage. 	<ul style="list-style-type: none"> • Affected appearance. • Compromised structural integrity. 	<ul style="list-style-type: none"> • Avoid using strong corrosive cleaners. • Repair small scratches and cracks with plastic repair agents. • Replace parts that are severely damaged.
Power Switch	<ul style="list-style-type: none"> • Frequent key operations leading to wear. • Internal circuit damage from moisture or aging. • Dust accumulation affecting contact. 	<ul style="list-style-type: none"> • Key failure. • Poor contact. • Malfunctioning indicator lights on the panel. 	<ul style="list-style-type: none"> • Clean with a soft cloth. • Check and repair internal circuit connections. • Replace damaged electronic components.

MAINTENANCE

- Perform daily cleaning by wiping dust with a soft, dry towel.
- Remove heavy dirt using a soft towel with diluted neutral detergent, followed by scrubbing with a dry towel.
- Avoid using benzene, diluent, gasoline, or other solvents, as they may damage the leather or corrode the product's appearance.
- Do not expose the product to strong sunlight or a moist environment, as this may cause damage.
- Use the product within the temperature range of -5°C to 50°C and humidity levels of 45% to 85%.



www.avcllc.com

sales@avcllc.com

972-623-6488

Garland, TX